

FRONT ELEVATION
(VIEW FROM PROVIDENCE ROAD)

ST. MARY MAGDALEN PARISH • CAPITAL CAMPAIGN



Dear Brothers and Sisters in Christ,

We are blessed to be members of a thriving faith community, where parishioners are sharing faith with each other and connecting as a family through our many ministries and organizations and through our school and religious education programs.

Since 1963, our church has been a gathering place, a resting place, and a place of encounter with God. We stand in gratitude to the numerous parishioners, priests and sisters who blessed us with wonderful facilities in the past. I invite the parish family to stand united in the same spirit, **BUILDING GOD'S HOUSE IN OUR TIME.**

To serve our growing community now and in the future, the parish recognizes, after extensive meetings, studies and prayerful reflections, the need for a larger worship facility and additional meeting areas and business offices. Our church will continue to be a beautiful symbol of our growing parish. The more we worship God and grow in faith, the more we will support religious education and works of charity.

Please prayerfully consider all of the information and participate in **BUILDING GOD'S HOUSE IN OUR TIME.** Together, we can pass on the Catholic legacy we have received from so many hearts and hands.

The Lord's Grace and Peace,

Rev. Ralph J. Chieffo

Rev. Ralph J. Chieffo, Pastor

"How lovely is your dwelling place, O Lord."

— Psalm 84



"Father Chieffo, please go forward and build our new church. My grandparents would be so very proud, and so will my parents, children, and thousands of people whom we do not even know — appreciative Catholics who will move into our community and carry on our Catholic faith long after you and I are gone."

— Larry, Joanne, Matt, John and Annie Bobiak



Building God's House . . .



provided by Murphy Architectural Group

"We love the spirituality and generous hearts of St. Mary Magdalen Parish. We believe that a new church is necessary to preserve that spirit. The more generous spaces for worship will enhance the meaning of the sacraments for every person in a growing community. The ancillary spaces will fill the need for adequate facilities for the parish to undertake its activities in the service of God."

— David and Libby Franklin

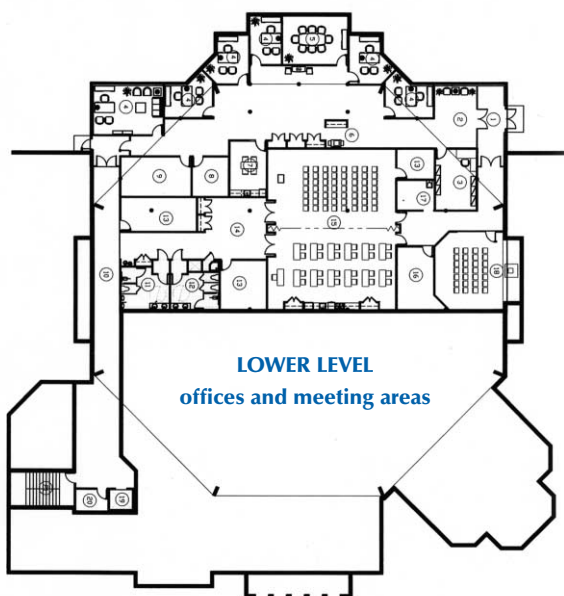
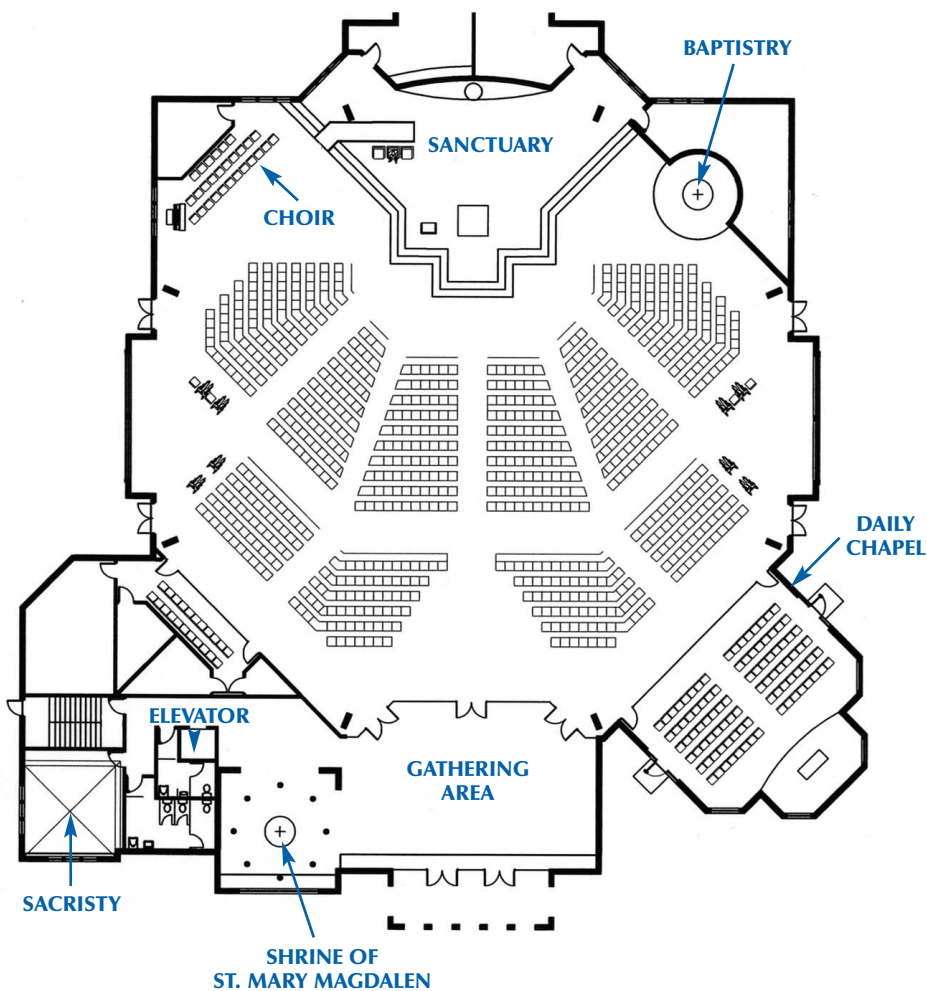

"As long time parishioners we are thrilled to be a part of the campaign to build a new church for our St. Mary Magdalen family; our spiritual home for years to come."

— Rudy and Ann Chillemi

... In Our Time

Project costs are estimated to be \$6.1 million and we are conducting a capital campaign to help fund them. While our campaign seeks to raise a minimum of \$2.5 million, the more we raise the stronger our parish's financial picture will be as the parish is committed to providing the balance. We are already blessed with a \$1,000,000 challenge gift and a campaign team of more than sixty and growing. Please join us.

We invite you to reflect on the objectives we have detailed, and in consideration of how they will serve to strengthen parish life for St. Mary Magdalen, decide your own level of support. The range of gifts projecting our \$2.5 million minimum goal encourages multi-level gifts or pledges. Your gift is personal and confidential.

WAYS OF GIVING

† Direct Gifts † Naming Opportunities

† 3-Year Pledges † Stocks and Bonds

Annual pledge payments are tax deductible.

HOW CAN YOU HELP?

- † Please pray for the success of the capital campaign.
- † Welcome those who come to call on you. Remember that every parishioner involved in the campaign is a volunteer.
- † Reflect on your level of participation. There are a variety of gift options, making it possible for everyone to feel ownership and pride in their participation.
- † Consider joining one of the committees. Your support is critical to the capital campaign's success.
- † Check with your employer for matching gift programs.

"We are blessed in our parish to provide a safe, beautiful facility for our children to learn about their faith and further their education. Now is the time for us to build a place of worship where we can gather as a family of God."

— Pat Miniszak



1963 — A Humble Beginning . . .

- † Since its humble beginning in 1963 with 143 families from Nativity BVM in Media and 13 families from St. Anastasia in Newtown Square, the parish has grown to nearly 1,600 families.
- † The founding pastor, Rev. Gilbert J. McDevitt, celebrated the first masses in a barn chapel. On January 23, 1966, our faith community began to worship in the new combination chapel and school building.
- † Monsignor Richard J. Simmons succeeded Fr. McDevitt after his death in 1967. A growing parish made the construction of our present church necessary. The first mass was offered on Christmas Day of 1970.
- † In 1973, Rev. John J. Walsh became the third pastor, and Rev. Joseph S. Rodgers succeeded him. In 1981, Rev. James F. Hughes was named pastor. Under his stewardship, the parish center was built in 1985, Maria Hall in 1991, and Sister Kathleen Hall in 1998.
- † Upon the retirement of Fr. Hughes, Rev. Ralph J. Chieffo was appointed pastor in June 2000. St. Mary Magdalen Parish continues to develop a family of faith in Jesus Christ through Catholic worship, education, and charity.

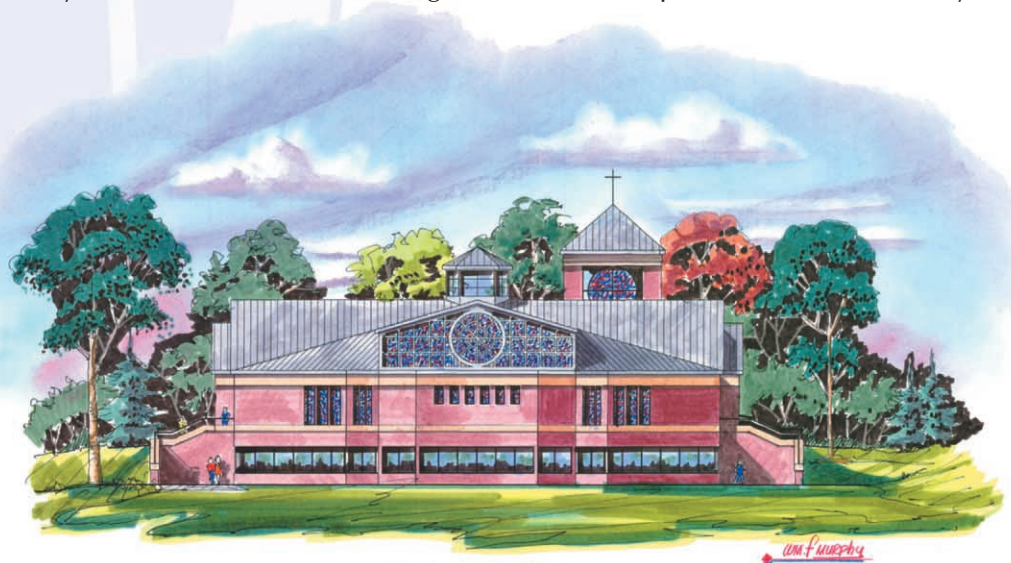

Today . . . A Changing Landscape

Saint Mary Magdalen Parish Population Growth Trends

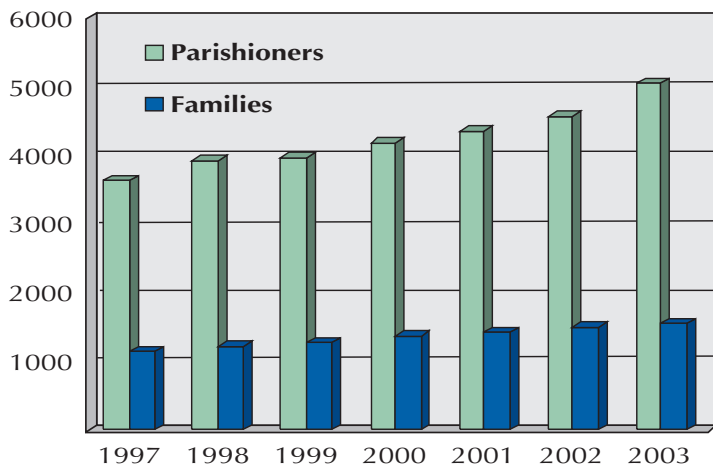

Our growing faith family has increased to 1,560 families with a census of 5,100 parishioners. Additionally, as we grow the impact on the ability of our fifty-five outreach ministries and organizations to have adequate workspace with which to support an expanding population will be compromised.

By building a new church now, we have the opportunity to upgrade our facilities and serve an expanding population.

Our parishioners have worked very hard in a variety of parish activities and have volunteered many hours of their time connecting as a faith family through our ministries and organizations. Good stewardship requires that we willingly accept our responsibility to carry the parish's mission forward into the 21st century. As the parish moves to "Build God's House in Our Time," we will bear witness to that same spirit serving as the hallmark of this endeavor.

SAINT MARY MAGDALEN MISSION STATEMENT

We, the parishioners of St. Mary Magdalen Parish recognize our call to develop as a community of faith by: proclaiming the Good News of Jesus Christ; meeting the needs of His people; and empowering our members to fulfill the mission of the Church.

"All of us love our Catholic faith. I cannot help but think of our parents and grandparents who built such beautiful churches. Together, we can build a beautiful new church where we can lift our minds and our hearts up to God, and share our faith with each other."

— Rose Ann Yannacone



- Adult Choir
- Adult Faith Formation
- Altar Servers
- Altar Society
- Baptismal Prep
- Bereavement
- CCD-PREP
- Centering Prayer
- Children's Liturgy
- Church Care
- Cluster Representative
- CYO
- Eucharistic Ministers
- Faith Sharing Groups
- Finance Committee
- Food Collection
- Greeters
- Guitar Group
- H.O.P.E.
- Home & School
- Hospitality
- Lectors
- Landings
- Legion of Mary
- Little Church School
- Liturgy
- Marriage Encounter
- Marriage Prep
- Men's Faith Sharing
- Moms In Touch
- Mornings for Mothers
- My Brother's House
- Neocatechumenal Way
- Pastoral Council
- Perpetual Adoration
- Prayer Chain
- Religious Education Board
- Respect Life
- RCIA
- School Endowment
- Scouts
- Scrip
- Scripture Society
- SMM Messenger
- SMM Seniors
- Stewardship/Tithing Committee
- Sunday Socials
- Ushers
- Vocation Icon
- Youth Choir
- Youth Ministry



Saint Mary Magdalen Parish
2400 North Providence Road
Media, PA 19063
610-566-8821